

NOTE - Your display shape may vary from the one shown below. Your wall display should have included the following items: 1 display, 2 fixture screws with rubber tips, 2 long fixture screws (optional) for mounting sword-in-scabbard, 2 wall screws, 2 plastic drywall anchors, round felt-covered pads (optional). READ ALL INSTRUCTIONS FIRST BEFORE PROCEEDING.

## DISPLAY ASSEMBLY

Display includes 4 sets of pre-drilled holes on the back side (Fig. 1). Two outer holes are for sword-in-scabbard display, and two inner holes are for display of the sword only (Fig. 7). Choose which way you want to display, then screw the two L shaped rubber-tipped fixture screws into the appropriate pre-drilled holes on the BACK of the display FIRST, just enough to puncture small pilot holes through the front side (Fig. 2). SECOND, remove and reinsert screws through the FRONT side pilot holes. Be careful not to screw in too far or the sword will not fit over the fixture screws. You can also drill these holes through the front side with a matching drill bit size if desired. Check the sword fit (Fig. 6). If the sword fits too tight, loosen fixture screws.

Apply (optional) protective adhesive-backed felt pads to back, if needed, to prevent scratching of the plaque on wall. Do not mount the sword on the display until it is securely mounted to the wall.

## MOUNTING DISPLAY TO WALL

Measure the distance between the two keyhole-shaped holes on the back of the display (Fig. 1). Mark the hole locations on the wall where the display will be mounted and screw the two wall screws into location. If you are mounting in drywall and want a secure fixture, mark your hole locations and drill holes slightly smaller than the diameter of the plastic wall anchors. Tap wall anchors into drywall and screw two wall screws into wall anchors. Leave approximately 1/4" (6.4mm) of the wall screw exposed (Fig. 3). For the most secure mount, find a stud in the wall where the display will be mounted using a stud finder and drill at least one screw directly into stud.

Position the large keyholes on the back of the display directly over the screws. Push the plaque flush against the wall (Fig. 4) and slide down to lock the screws in place (Fig. 5). If the display will not slide down loosen the screws and repeat.

FIGURE 1

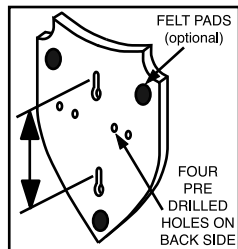

FIGURE 2

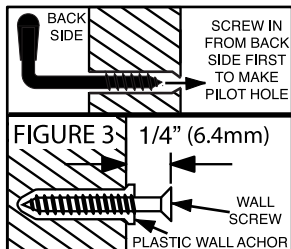

FIGURE 4

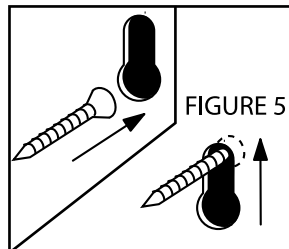

FIGURE 6

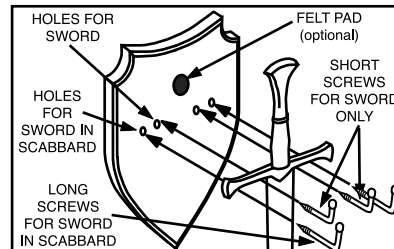

FIGURE 7

